

GAOKEview Interactive Flat Panel

E series

GSTL-C3 CVT982-Classic



Zero Bonding
Technology



Full-function
Type-C



Multi-tasking
Android



Dual colors pen



4K Camera



Auto-backlight



Touch lock



Screen Mirror

| Model Num | I UVN/Z;/: 8U | I UVN/Z;/98U | I UVN/Z;/110U |
|-----------------------|----------------------|-------------------------|-----------------------|
| Size | 81pej | 98inch | 110inch |
| Backlight Type | D-LED | D-LED | D-LED |
| Panel Brand | BOE | BOE | BOE |
| Resolution(pixels) | 3840x2160 | 3840x2160 | 3840x2160 |
| Brightness | ≥400cd/m2(typ.) | ≥400cd/m2(typ.) | ≥400cd/m2(typ.) |
| Aspect Ratio | 16:9 | 16:9 | 16:9 |
| Contrast Ratio | 1600:1/1200:1 | 1600:1/1200:1 | 1600:1/1200:1 |
| Response Time | 6ms (typ.) | 6ms (typ.) | 6ms (typ.) |
| Pixel Pitch (mm) | 0.4935(H)x0.4935(V) | 0.5622(H)x0.5622(V) | 0.4935(H)x0.4935(V) |
| Refreshing Frequency | 60Hz | 60Hz | 60Hz |
| Viewing Angle | 178°(H)/178°(V) | 178°(H)/178°(V) | 178°(H)/178°(V) |
| Life Time | 50,000 Hrs(min.) | 50,000 Hrs(min.) | 50,000 Hrs(min.) |
| View Area (mm) | 1650.24(H)x928.26(V) | 2158.848(H)x1214.352(V) | 2436.48(H)×1370.52(V) |
| Color Gamut (X% NTSC) | 72%(NTSC) | 72%(NTSC) | 72%(NTSC) |
| Colorfulness | 1.07B(10 bit) | 1.07B(10 bit) | 1.07B(10 bit) |

System

| | |
|------------------------------------|--------------------------------------------------|
| Chipset | Amlogic T982 |
| CPU Architecture&Working Frequency | Quad-core A55, 1.8GHz for Standard, 2GHz for Max |
| GPU | Mali G52MP2 |
| RAM | Standard: 4GB DDR4, 8GB optioanl |
| ROM | Standard: 32GB, 128GB optional |
| OS | Android 13.0 |
| Power Requirements | AC 100 V ~ 240 V, 50/60 Hz |
| 86" Power Consumption Without OPS | 440W |
| 98" Power Consumption Without OPS | 610W |
| 110" Power Consumption Without OPS | 760W |
| Standby Condition | < 0.5W |
| Audio Output Power | 15W*2 |
| Subwoofer(Optional) | 20W*1 |

Front Interface

| | |
|-----------------------|----|
| Public USB3.0 | x3 |
| Touch USB | x1 |
| HDMI IN | x1 |
| Type-C(Full Function) | x1 |

Rear Interface

| | |
|---------------------------|----|
| RJ45 | x1 |
| AUDIO IN | x1 |
| EARPHONE(3.5mm AUDIO OUT) | x1 |
| VGA IN | x1 |
| SPDIF OUT | x1 |
| RS232 | x1 |
| USB 2.0 | x1 |
| USB 3.0 | x1 |
| HDMI IN 1(EARC) | x1 |
| HDMI IN 2(UART) | x1 |
| TOUCH USB | x1 |
| MIC IN | x1 |

Network

| | |
|------------------------|------------------------------------------------|
| Wired Network | Support 10/100Mbps |
| WiFi Standard | Built-in dual-channel WIFI, support AP hotspot |
| WiFi Protocol | WiFi:802.11 b/g/n AP:802.11 a/b/g/n/ac |
| WiFi Working Frequency | WiFi:2.4GHz AP:2.4G&5GHz |
| WiFi 6 | Standard |
| WiFi Working Distance | 0~12m |

Bluetooth

| | |
|-------------------|----------|
| Standard | Built-in |
| Version | 5.0 |
| Working Frequency | 2.4Hz |
| Working Distance | 0~12m |

Camera(Optional)

| | |
|-----------------|--------------------------------|
| Quantity | 1 |
| Pixel | 13MP/48MP |
| Position | Middle Top |
| Field of vision | DFOV: 100° HFOV:91.9° VFOV:60° |
| Resolution | Support 4K (under Windows) |

Microphone(Optional)

| | |
|------------------|---------|
| Quantity | 8 |
| Pick-up Distance | 0-8m |
| View Angle | 0°~180° |

Touch Parameter

| | |
|--------------------------|-------------------------------|
| Touch Type | Infrared Touch Frame |
| Surface Protection | 4mm toughened glass |
| Infrared Touch | 20 Points/40 Points(Optional) |
| Interpolation Resolution | 32768 x32768 |
| Response Time | ≤6ms |
| Input Mode | Finger or Pen |
| Theory Clicks | Unlimited |
| Minimum Touch Object | USB+RS232 |
| Connect Type | 4.75~5.25V |

Structure Parameter

| Size | GSTL-X9-86S | 98inch | 110inch |
|---------------------------------------------|--------------------------------|--------------------------------|---------------------------------|
| Product Size(L x H x D) | 1953.2x1151.6x128.5mm | 2216x1303.4x133.9mm | 2500.6x1463.8x130mm |
| Package Size(L x H x D) | 2083x1290x210mm | 2356x1441.5x210mm | 2684.6x1625.1x301mm |
| Housing Material (Face frame/rear shell) | Aluminum/Metal Plate | | |
| Shell color (Face frame/rear shell) | Black&Gray/Black | Black&Gray/Black | Black&Gray/Black |
| VESA | 4-M8 Screw Hole 800mmx600mm | 4-M8 Screw Hole 800mmx600mm | 4-M8 Screw Hole 1000mmx800mm |
| Net Weight | 68±1KG | 92±5KG | 110±5KG |
| Gross Weight | 83±1KG | 110±5KG | 144±5KG |

Accessory

| | |
|------------------------|----|
| Remote Control | x1 |
| Touch Pen | x2 |
| Power Cord | x1 |
| HDMI Cable | x1 |
| TOUCH USB Cable | x1 |
| E-User's Manual | x1 |
| Wall Mount | x1 |
| Mobile Stand(Optional) | x1 |

Environment

| | |
|---------------------|-------------------|
| Working Temperature | 0°C~40°C |
| Working Humidity | 10%~90%RH |
| Storage Temperature | -20°C~60°C |
| Storage Humidity | 10%~90%RH |
| Working Altitude | Below 5000 meters |

Warranty

| | |
|---------------|---------|
| Warranty Time | 2 Years |
|---------------|---------|

Disclaimer

1. Due to the influence of many aspects such as configuration and manufacturing process, the actual size/weight of this product may vary. The specification is for reference only, please refer to the actual situation.
2. The product pictures attached to this specification are only for illustrative display, the actual effect (including but not limited to appearance, color, size) may be slightly different, please refer to the actual product.
3. The packaging materials for this product are designed in strict accordance with the storage conditions of this product.
4. Abnormalities caused by extreme weather and long storage time cannot be guaranteed to be completely avoided. Please be informed.
5. Please store in strict accordance with the required storage conditions. Improper storage may cause abnormalities.
6. In case of any situation involving the above modification and update, no prior notice will be given.

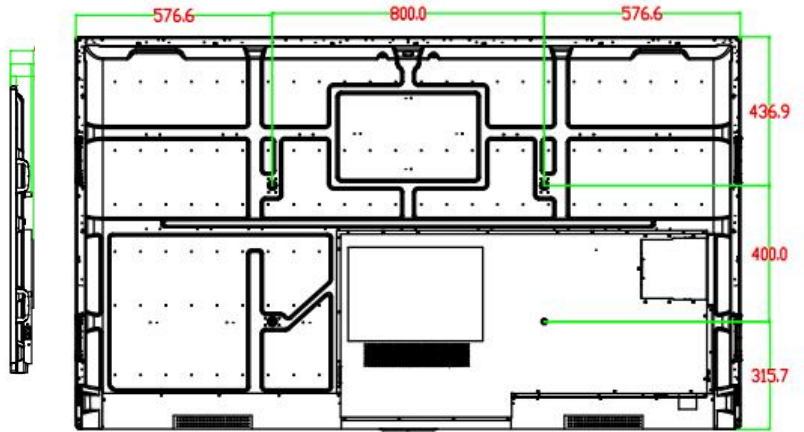

Product View-98inch

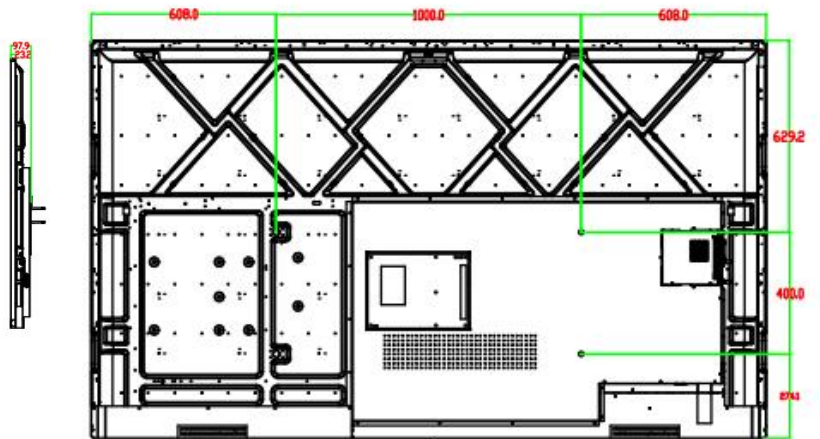
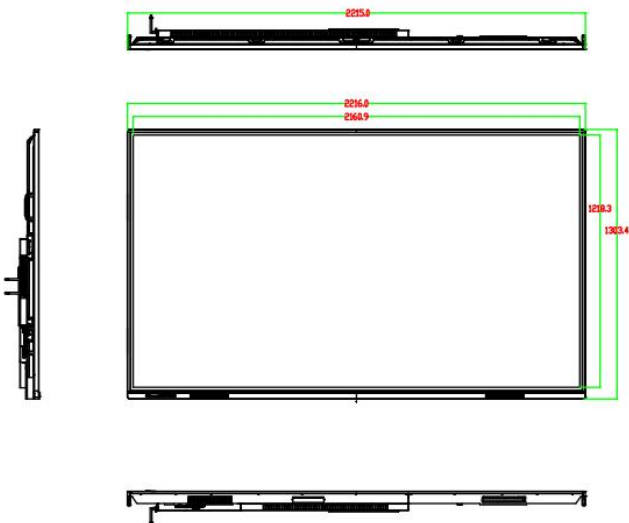

Product View-110inch

